

## INSTALLATION MANUAL FOR SURFACE MOUNT RTFFR4 AND RTFFR56 CCT



### SAVE THESE INSTRUCTIONS - READ ALL INSTRUCTIONS CAREFULLY

Provides surface mount light for new construction applications. Unit fits most 4" junction boxes can and fire rated boxes. It is also suitable for use in dry, damp or wet locations

## WARNING



CAN ICES-005 (B) / NMB-005 (B)

### PLEASE READ ALL INSTRUCTIONS BEFORE ATTEMPTING INSTALLATION.

- To prevent personal injury or product damage only licensed electricians/personnel should install fixture.
- To avoid electric shock or component damage disconnect power before attempting installation or servicing.
- This product must be installed in accordance with the National Electric Code (NEC) and all applicable Federal, State/Provincial and Local Electric Codes and Safety Standards.
- Risk of Fire Supply conductors (power wires) connecting the fixture must be rated minimum 90°C. If uncertain, consult your licensed electricians.

#### TECHNICAL SPECIFICATION

VOLTAGE: 120V, 60Hz AC operation  
 WATTAGE: 10W-20 pcs LED chips, 15W-28 pcs LED chips  
 LUMENS: 10W, 581 LM / 678 LM / 602 LM, CRI 80+,  
 15W, 949 LM / 1086 LM / 983 LM, CRI80+

#### COLOR

TEMPERATURE: 3000K / 4000K / 5000K  
 DIFFUSER: Translucent white PC opal diffuser  
 HARDWARE: All mounting screws and wire connectors  
 WARRANTY: 5 Years, limited warranty

## INSTALLATION

figure #1

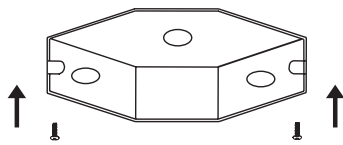

Step 1) Prior to installation, please install two screws (furnished) into the junction box. Do not drive screws completely to the end of the junction box.

figure #2

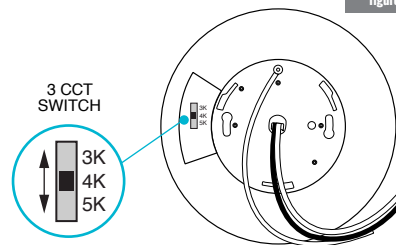

Step 2) Select Color Temperature on CCT Switch located on the back of the fixture.

figure #3

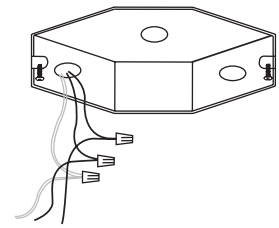

Step 3) Connect supply wires to wires in fixture wiring box with proper size wire nuts or push wires into "push-in" connector. Connect white to white, black to black, and green or bare copper wire. The ground wire at the service junction box may need to be secured to a ground screw.

figure #4

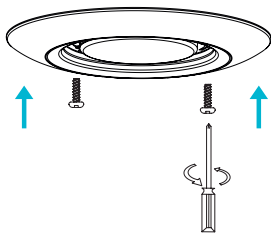

Step 4) With a Phillips screwdriver, attach the disk light tightly to the j-box.

figure #5

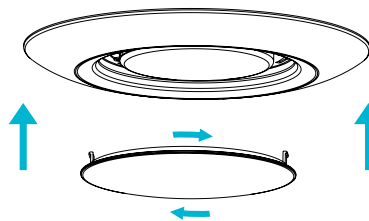

Step 5) Complete the installation by twisting the diffuser on the disk light aluminum enclosure and lock the diffuser in place.

figure #6

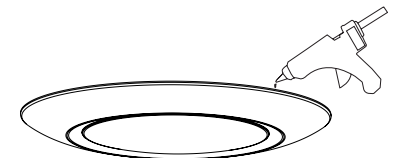

Step 6) The edge of the fixture and the ceiling use waterproof silicone to seal.